

» POWERMAST FIELD REPLACEMENT KIT INSTRUCTIONS

These instructions are for the parts included in the PowerMast Field Replacement Kit, which makes it easier to replace parts in the field.

A. WORM SHAFT COUPLER ▾

- Place the coupler onto the gearbox hex drive shaft, aligning the set screw to the dimple in the shaft.
- Apply a small amount of Loctite to the set screw, use the Allen wrench to turn the set screw until tight, then loosen one quarter rotation so the coupler wiggles freely but doesn't come off.

B. 3/8 IN. LOCK WASHER ▾

- When assembling the drill bracket, place this washer under the nut before tightening.

C. DRILL BRACKET ▾

- This bracket attaches to the mast just above the gearbox. Using a 9/16-inch wrench, tighten the bracket onto the mast. This bracket assembly can be assembled and tightened by hand if a single component of the bracket needs to be replaced.

D. PLATFORM HOLD DOWN ▾

- Using the existing nuts and bolts, attach this assembly to the mast.

E. CLIMBING UNIT LOCK PIN ▾

- This pin attaches to the mast and can be twisted in by hand. Each mast should have four of these, as shown in the figure to the right.

F. BRACKET TIE MOUNT ▾

- This bracket connects to the mount assembly that is attached. To place this bracket, take out and reuse the existing bolt and nut. Use a 9/16-inch wrench to tighten the nut on the bottom of the bolt.

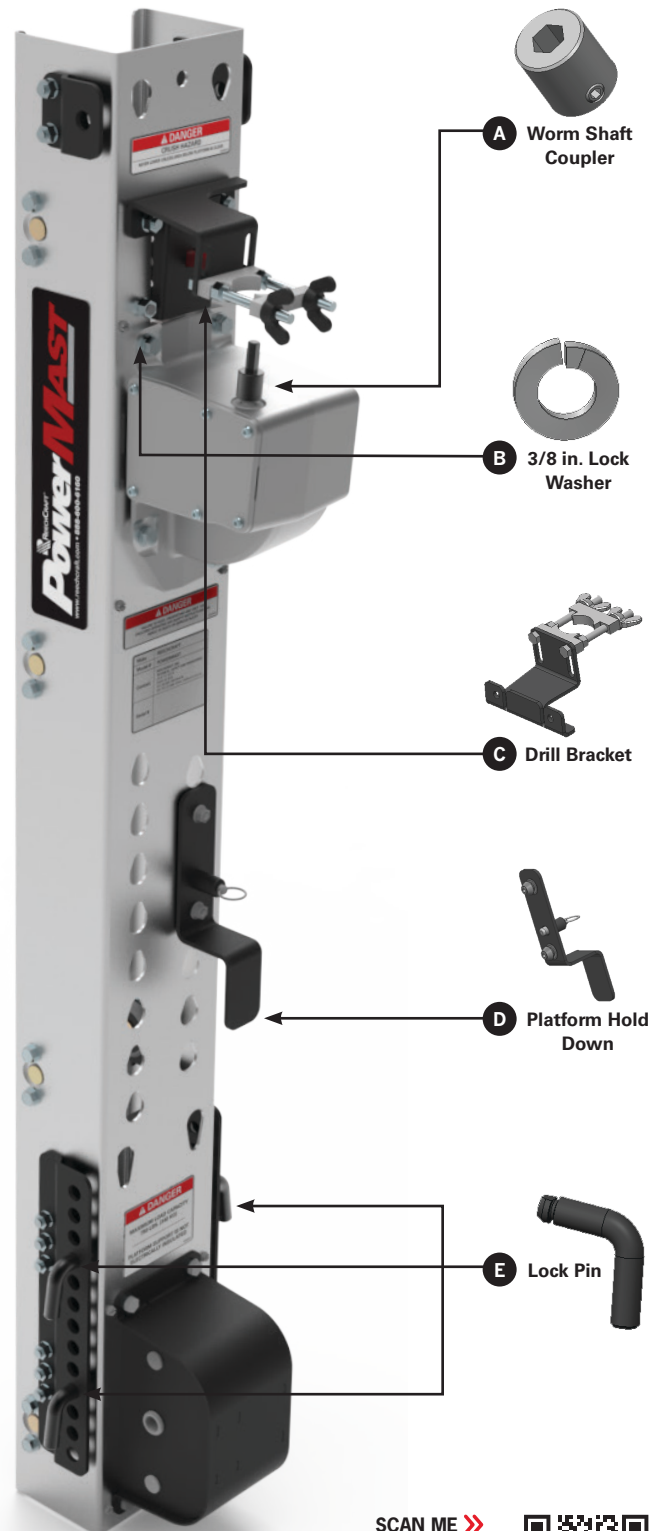
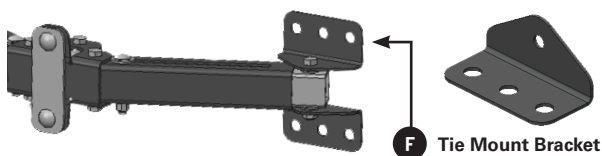

SCAN ME »

Scan the QR code to view parts list kit instructions, and more.

